

INSTRUCTIONS TO NAVIGATION ROOM FRAME

A few tips for removing supports from parts:

- Use side cutters or a SHARP knife
- When cutting the support, also support it with your finger on the other side
- First remove the parts from each other and then from the supports
- There is two sizes of supports. Remove the thick ones first. The smaller ones may even detach themselves after that. See picture 1
- In the thinnest pipes, I recommended to start removing the supports in the middle and proceed to the ends. But before that the thick ones. See picture 2.
- The set includes a few spare parts

1

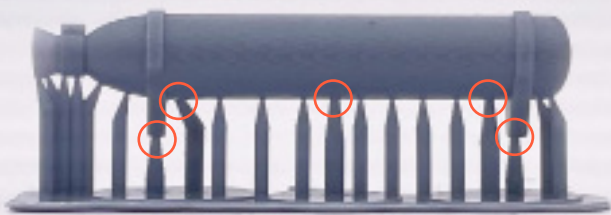

Example image: 5 thicker supports in the image

2

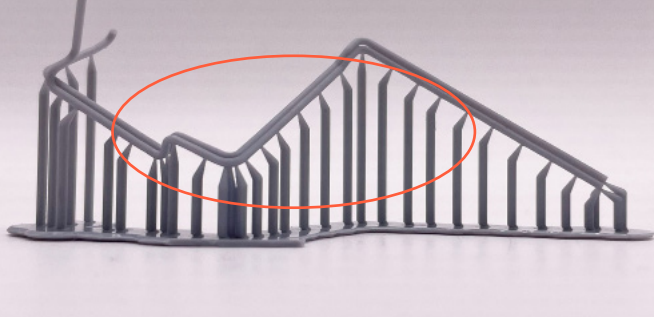

Modifications

- If you bought the upper part of the navigation room separately, you will need to remove three parts of the Hull from the floor to make the parts fit

Navigation room Frame

The parts you need to build the lower frame of the navigation room Body in one piece and resin sheet 8. The set also includes one part (Pipe) that is supposed to be attached to the battery room 1. The part is also included in the updated battery room 1 series (marked red in lower picture)

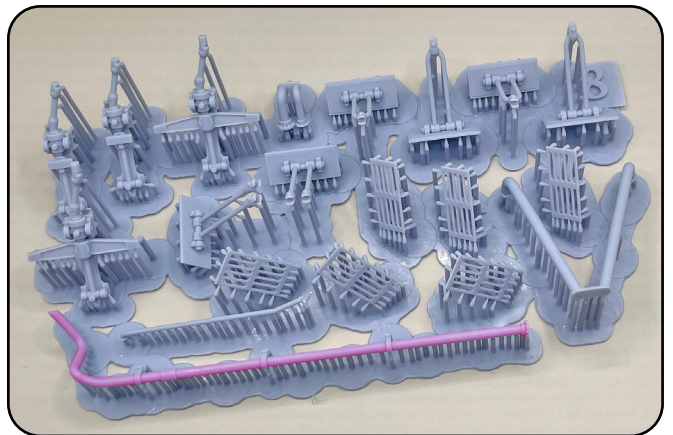
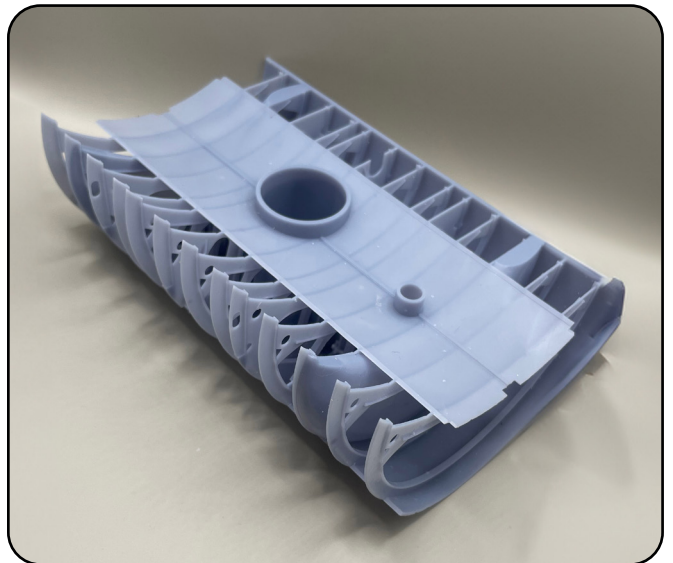

If some parts look different in the instructions than the kit. You just received the updated part. The better one

NAVIGATION FRAME

SHEET 8

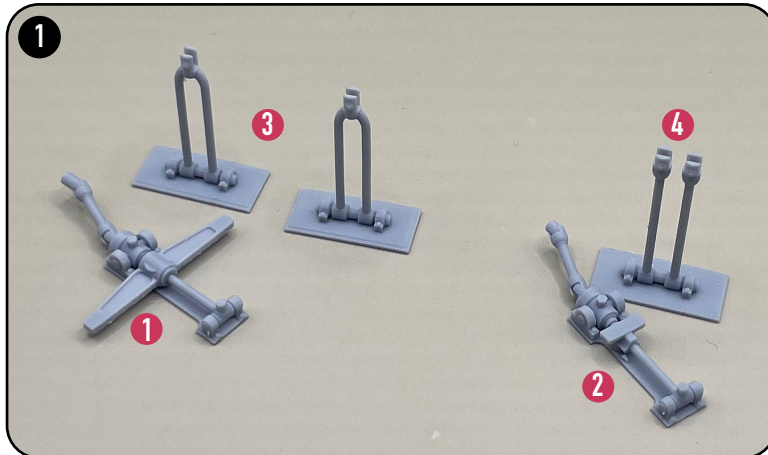

FLOOD LEVERS

- 1: Remove all parts. Only the parts of the other side are shown in the picture. Both sides are installed in the same way.
- 2: If you look closely, there is a small mark in the part. Cut the part off using side cutters.
- 3: Result

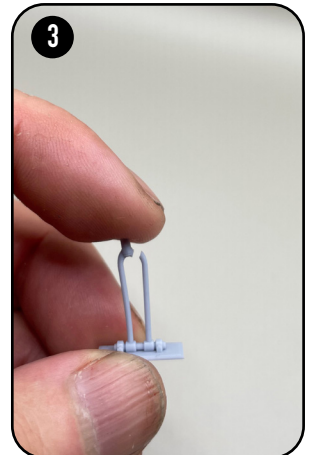
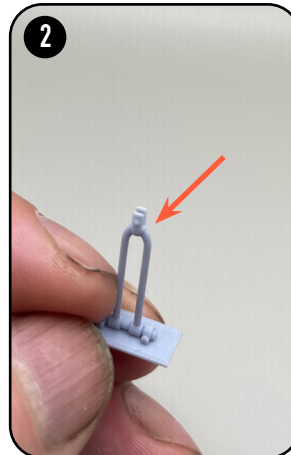

INSTALLING PARTS

- 1: Glue parts 1 and 2 to the frame.
- 2: Install parts 3 and 4 through the holes on the bottom of frame. See Picture 4.

The following pictures show the end result and how parts 1 and 3 / parts 2 and 4 come together.

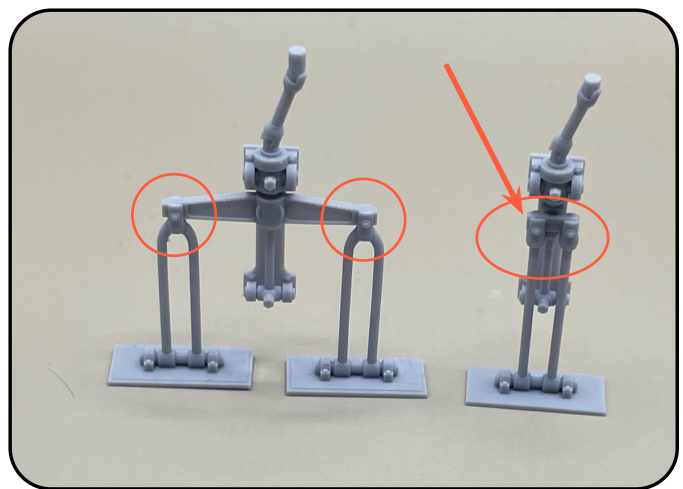
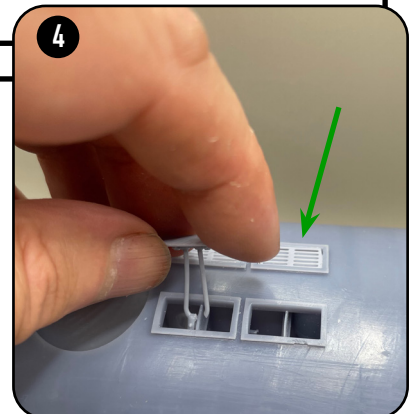
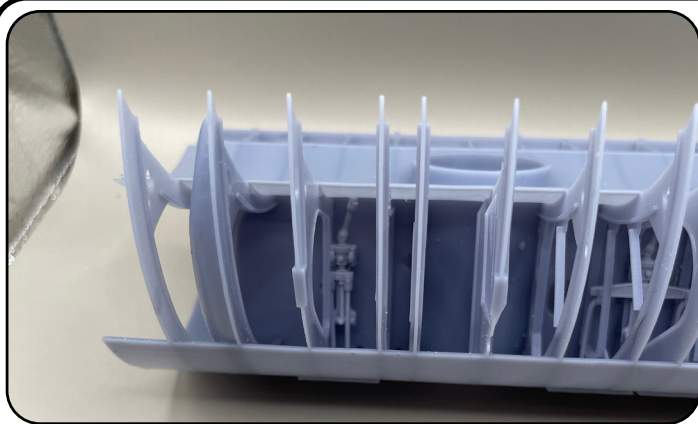

Finally glue the grilles in place. (See picture 4 again and green arrow)

PIPES

TRIM / FLOOD PIPES

To install all the pipes you need to open the bulkhead as they are in the real VIIC U-Boat. It is recommended anyway when making a model that is as authentic as possible. You can see the cutting templates in the later pictures.

In the examples in these pictures, I have not opened the bulkhead myself. Pipes 2, 3 and 4 can also be installed without an opening.

Pipe number 1 should be glued to Underground 3D Project battery room number 1 kit and it probably also fits Trumpeter's own battery room kit, if you don't have Underground 3D Project's battery room kit.

Pipe number 2 is glued to Underground 3D Project's battery room 2 kit or uncut navigation room bulkhead.

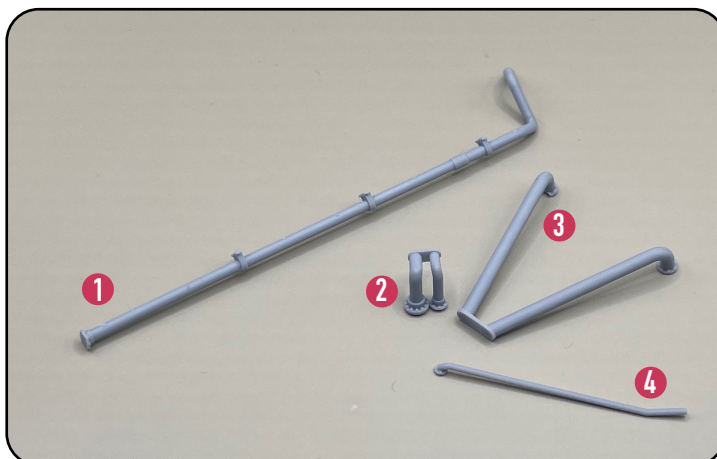

INSTALLATION PICTURES

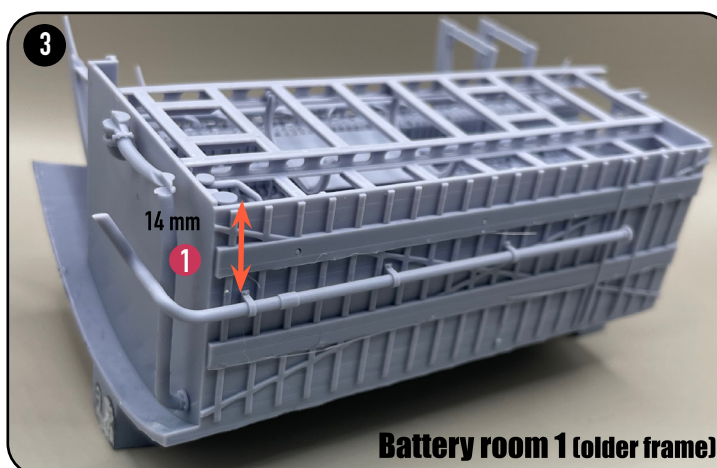
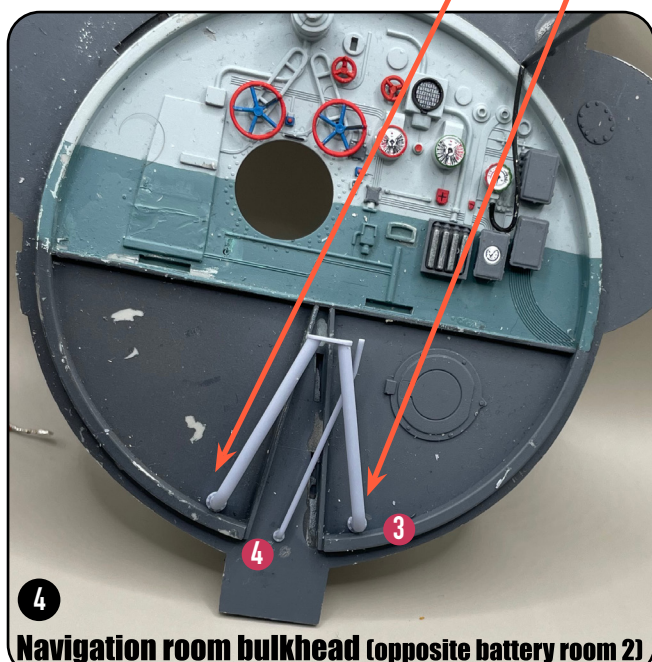
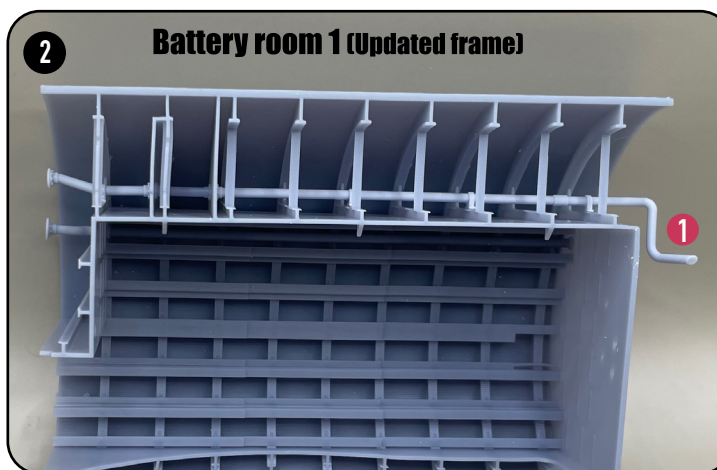
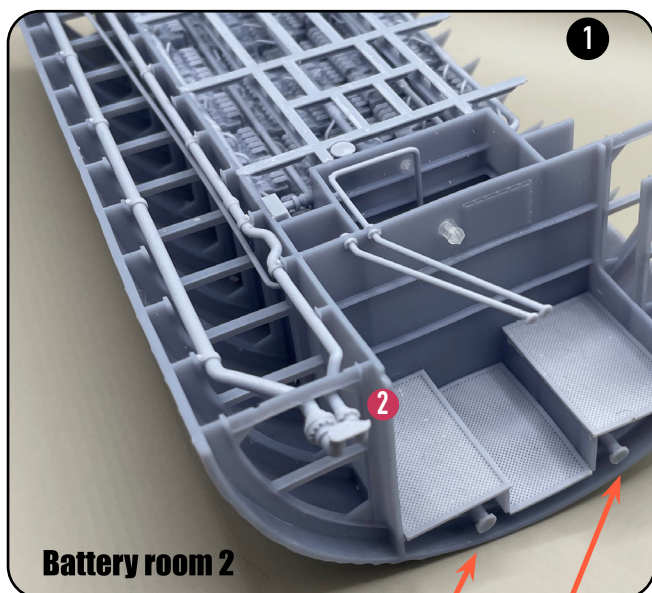

If you don't cut the bulkheads open, glue these pipes to the bulkhead of the navigation room. Otherwise to battery room 2 bulkhead

NOTE: In the finished model, you can't see the difference between the old and new frames of the battery compartment 1

BULKEHAD CUTTING TEMPLATES

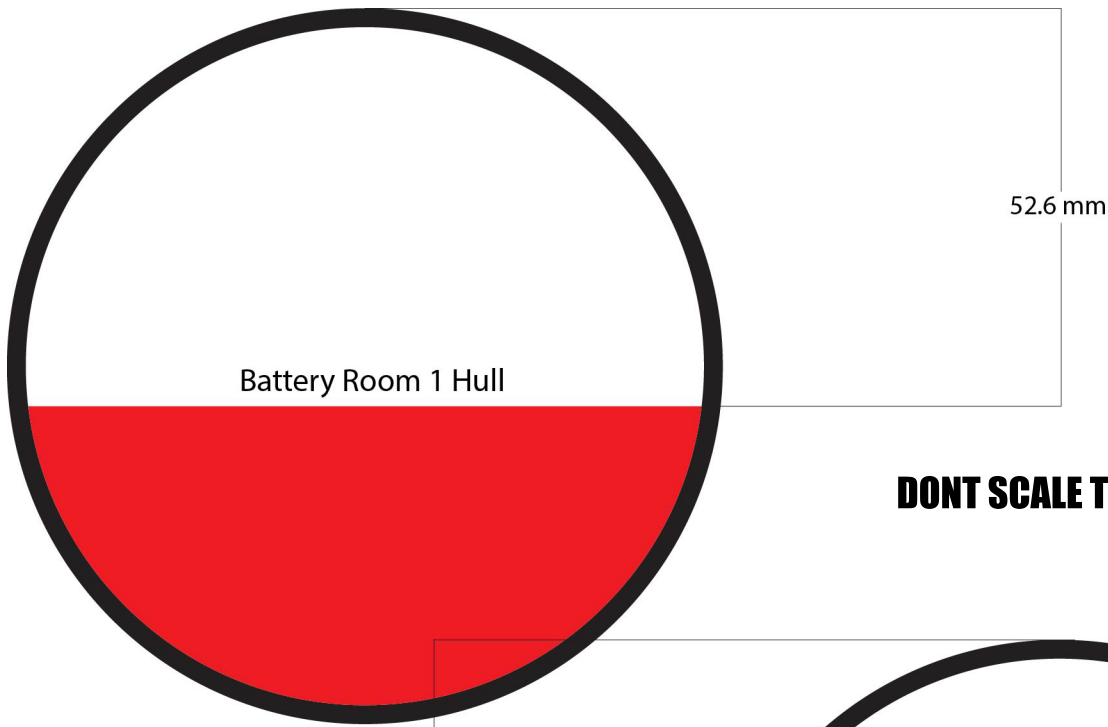

DONT SCALE THIS PAGE

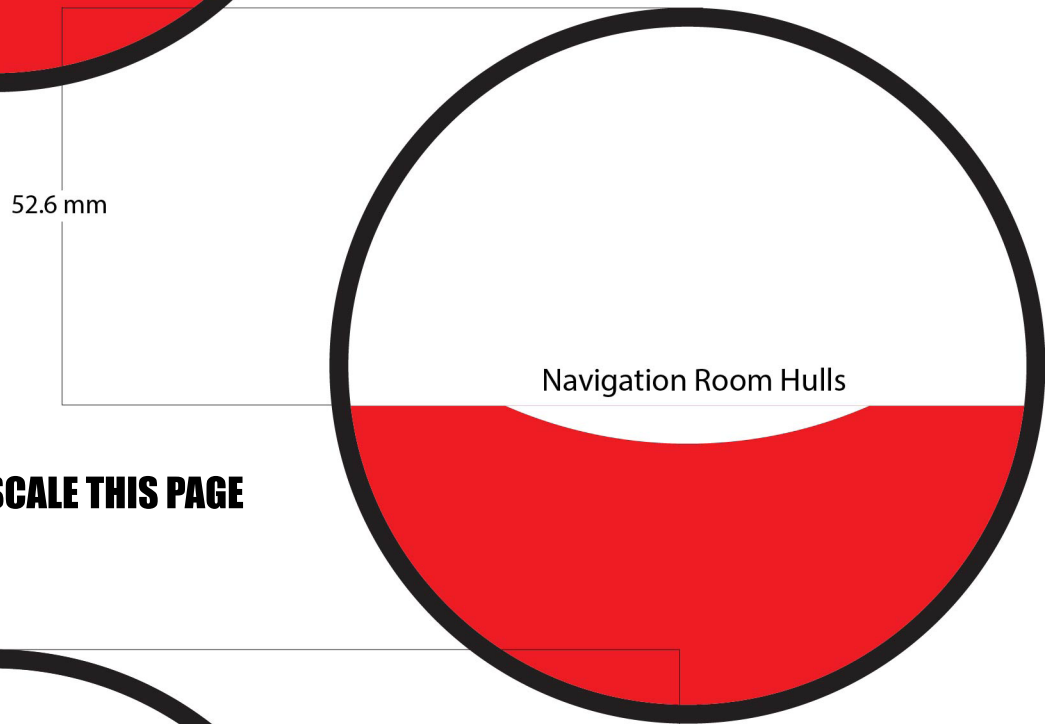

DONT SCALE THIS PAGE

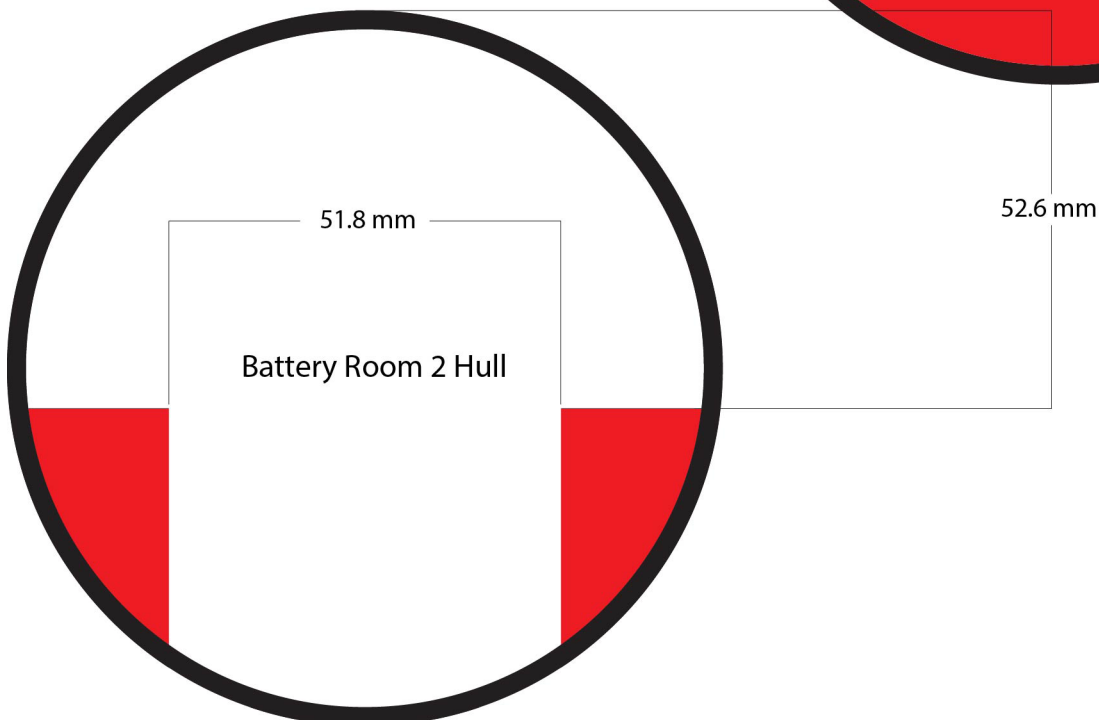

EXAMPLE PICTURE WITH BULKHEADS

